

TruTorque

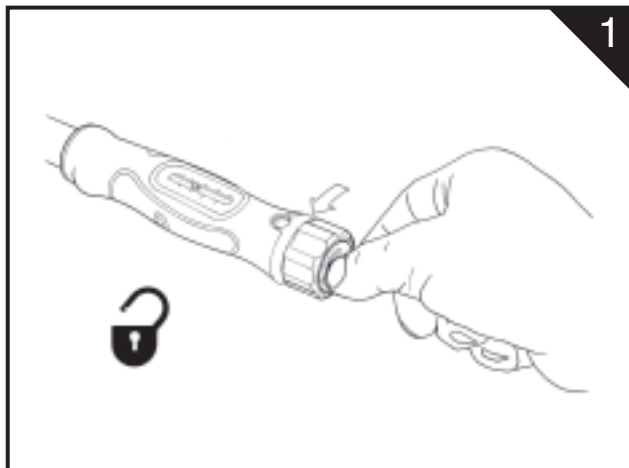

- Unlock • Déverrouiller la mollette
- Entsichern • Sbloccare • Desbloquear

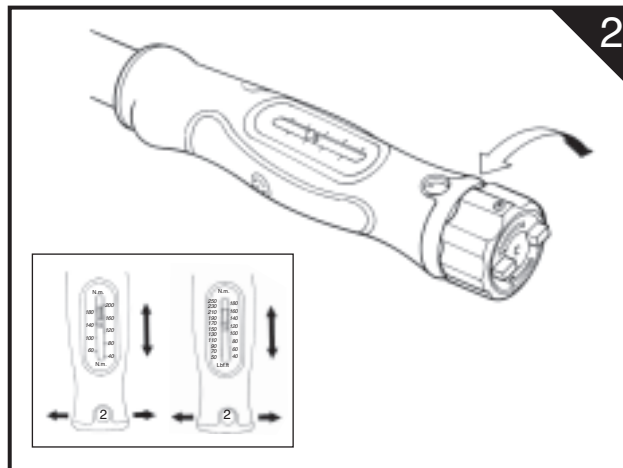

- Adjust • Régler • Einstellen
- Regolare • Ajustar

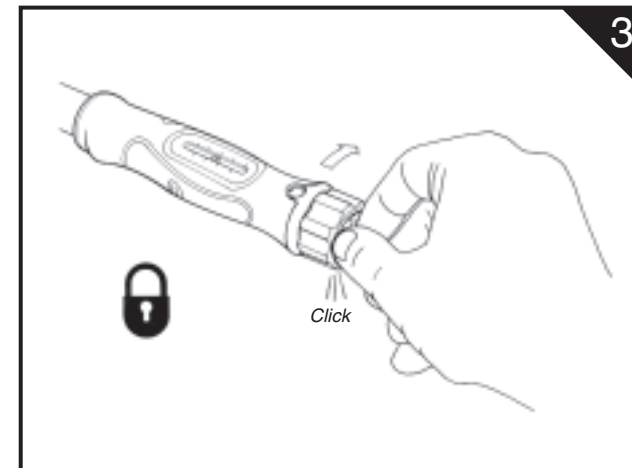

- Lock • Verrouiller la molette • Sichern
- Bloccare • Bloquear

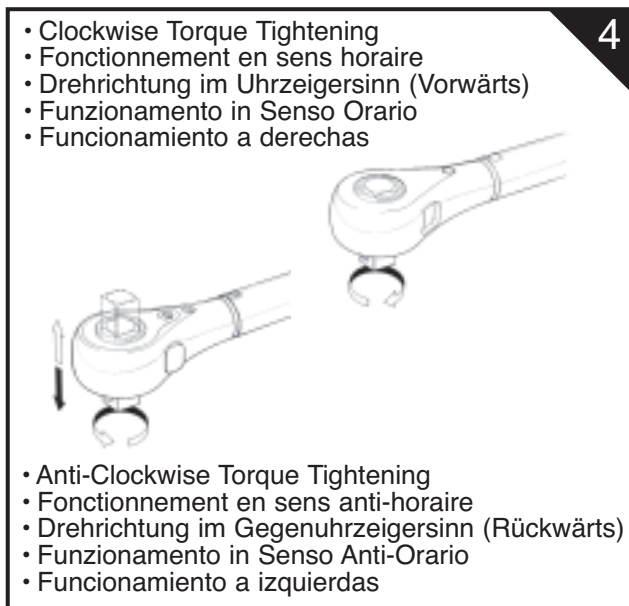

- Clockwise Torque Tightening
- Fonctionnement en sens horaire
- Drehrichtung im Uhrzeigersinn (Vorwärts)
- Funzionamento in Senso Orario
- Funcionamiento a derechas

- Anti-Clockwise Torque Tightening
- Fonctionnement en sens anti-horaire
- Drehrichtung im Gegenuhrzeigersinn (Rückwärts)
- Funzionamento in Senso Anti-Orario
- Funcionamiento a izquierdas

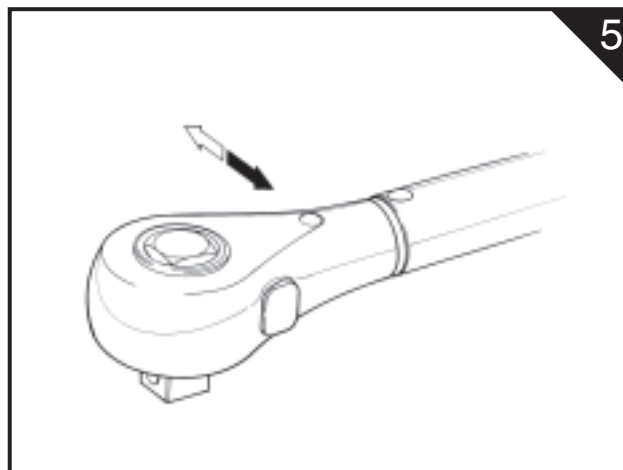

- Set ratchet direction • Régler la direction de serrage
- Wahl der Arbeitsrichtung
- Fissare direzione cricchetto • Seleccionar

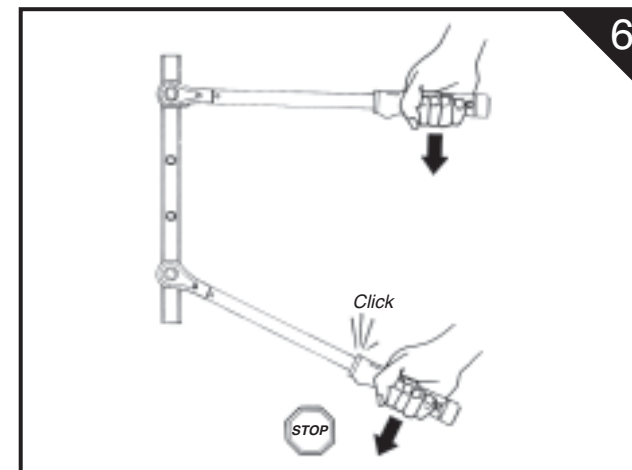

- Apply Torque • Appliquer le couple
- Drehmoment Anwendung • Applicare la coppia
- Aplicar el par de apriete